

SINGLE CAR SHELTER 12'

Please read the instructions carefully and verify the pieces before starting the installation.





SINGLE CAR SHELTER 12'

BOLTS AND WING NUTS

Code part	Description	12'	16'	20'	24'	28'	32'	36'	40'
B1	Bolt ¼" x 1 ¾"	14	16	18	20	22	26	28	30
B3	Bolt ¼" x 3"	20	25	30	35	40	45	50	55
P	Wing nut ¼"	34	41	48	55	62	71	78	85

PARTS

Code part	Description	12'	16'	20'	24'	28'	32'	36'	40'
TOP12	Center arch	4	5	6	7	8	9	10	11
RA12	Arch brace	4	5	6	7	8	9	10	11
ACO12	Arch corner 1 hole	4	6	8	10	12	14	16	18
ACO212	Arch corner 2 holes	4	4	4	4	4	4	4	4
BP12F	Female door rail	2	2	2	2	2	2	2	2
BP12M	Male door rail	2	2	2	2	2	2	2	2
P112	Leg 1 hole	6	8	10	12	14	14	16	18
P212	Leg 2 holes	2	2	2	2	2	4	4	4
DIA	Diagonal brace	2	2	2	2	2	4	4	4
EF4	Female brace	5	5	5	5	5	5	5	5
EM4	Male brace	10	15	20	25	30	35	40	45
T	Shelter cover	1	1	1	1	1	1	1	1
P12	Door	2	2	2	2	2	2	2	2

HARDWARE

Code part	Description	12'	16'	20'	24'	28'	32'	36'	40'
S HOOK	S Hooks	12	12	12	12	12	12	12	12
ANNEAU	Shower hooks	12	12	12	12	12	12	12	12
ELASTIQUE	Elastics	12	12	12	12	12	12	12	12
ROPE	Rope	1	1	1	1	1	1	1	1

SINGLE CAR SHELTER 12'

PARTS

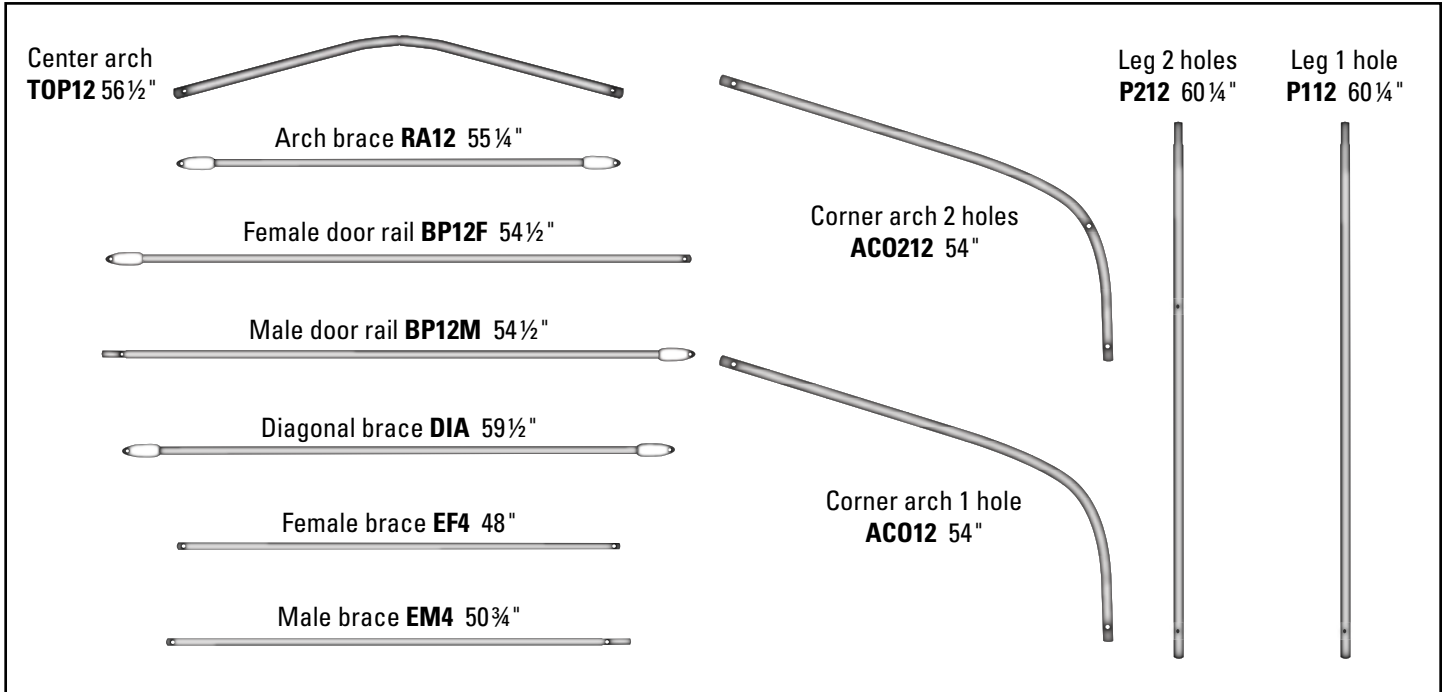

SHELTER VIEWS

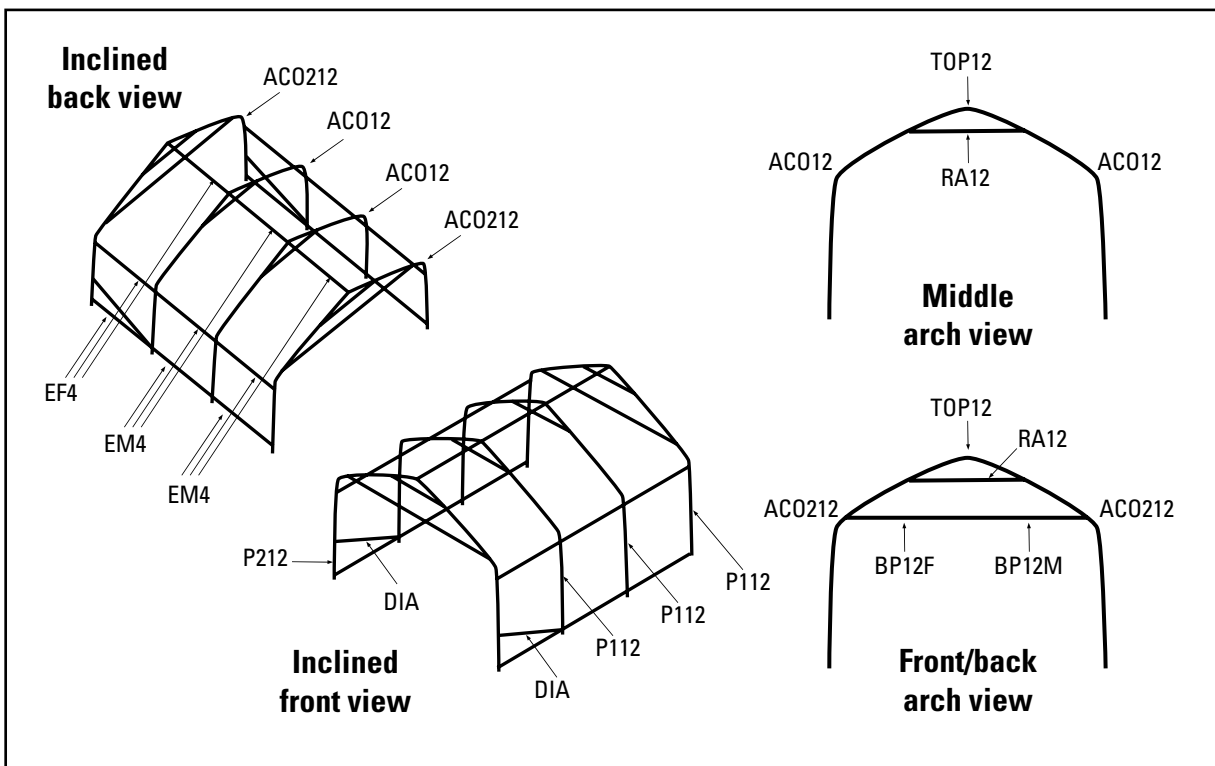

REQUIRED TOOLS (NOT INCLUDED)

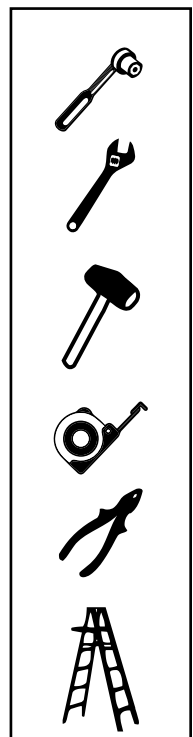

SINGLE CAR SHELTER 12'

INSTALLATION

1. Insert the arch corner 1 hole (**ACO12** for standard arch) in the arch center (**TOP12**). Complete the installation with the arch braces (**RA12**), the 1 3/4" bolts (**B1**) and the wing nuts (**P**).

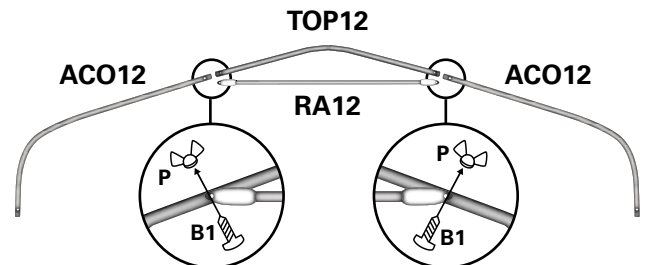

2. Insert the arch corner 2 holes (**ACO212** for front/back arch) in the arch center (**TOP12**). Complete the installation with the arch brace (**RA12**), the 1 3/4" bolts (**B1**) and the wing nuts (**P**).

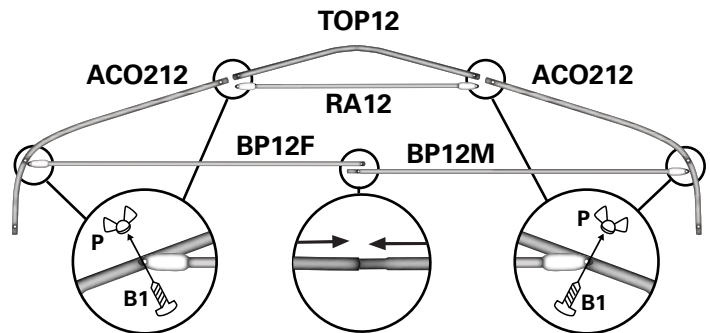

3. Assemble the female door rail (**BP12F**) and the male door rail (**BP12M**), then assemble it to the arch corner 2 holes (**ACO212**) with the bolt 1 3/4" (**B1**) and the wing nuts (**P**).

4. Assemble all the arches before starting to build the shelter.

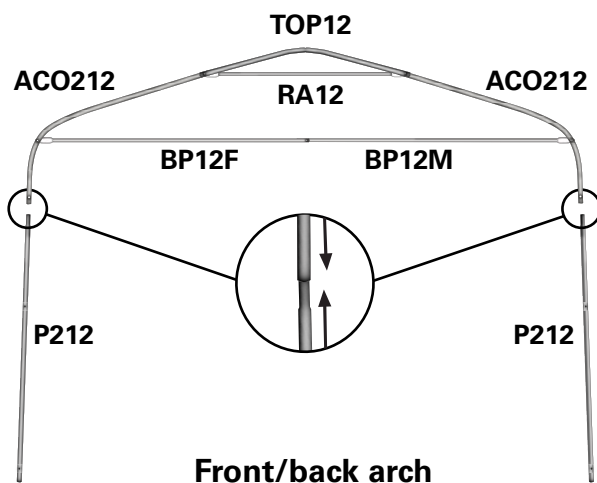

Front/back arch

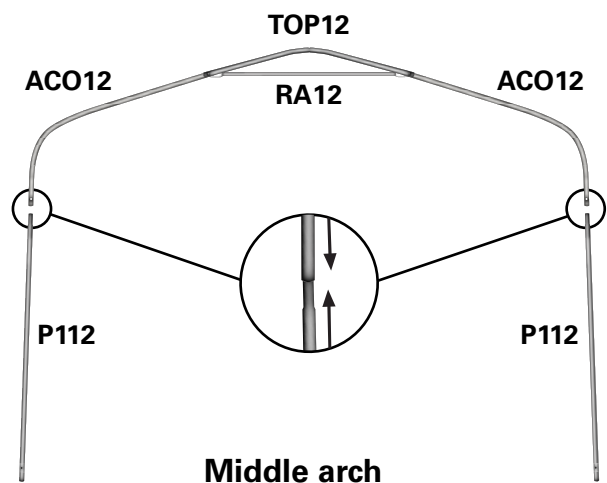

Middle arch

5. Add the 2 holes leg (**P212**) to both sides of the arch corner 2 holes (**ACO212**) for the FRONT arch.

Add the 1 hole legs (**P112**) to both sides of the arch corner 1 hole (**ACO12**).

Shelter 32' or longer: The FRONT arch and the BACK arch will be assemble with the 2 holes leg (**P212**).
Shelter 28' or shorter: Only the FRONT arch will be assemble with the 2 holes leg (**P212**) and the BACK arch will be assemble with the 1 hole leg (**P112**).

SINGLE CAR SHELTER 12'

6. Attach the FRONT arch to the middle arches using the females braces (EF4) and the diagonal braces (DIA) attached with the 1 3/4" bolts (B1) and the wing nuts (P) on the side of the legs 2 holes (P212).

SHELTER 32' OR LONGER: The FRONT and the BACK arches will be attached with the diagonal braces (DIA) on the side of the legs 2 holes (P212).

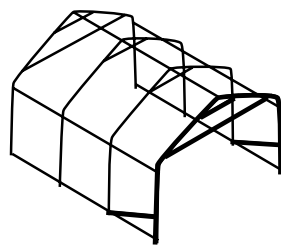

28' or shorter

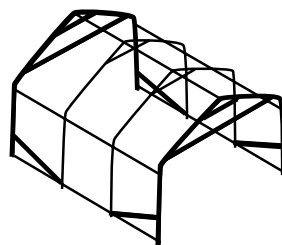

32' or longer

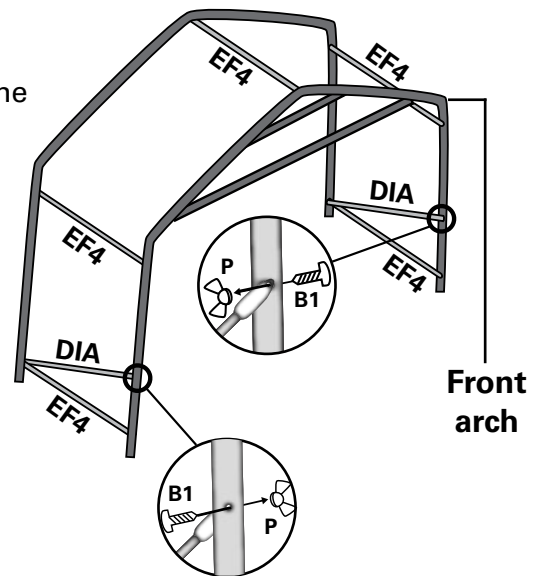

NB: The wing nuts (P), the female braces (EF4), the diagonal braces (DIA) and the male braces (EM4) must be installed **on the inner side** of the shelter. Doing so, prevents damage to the cover.

7. Finish assembling all the arches/legs with the male braces (EM4) by using the 3" bolts (B3) and the wing nuts (P)

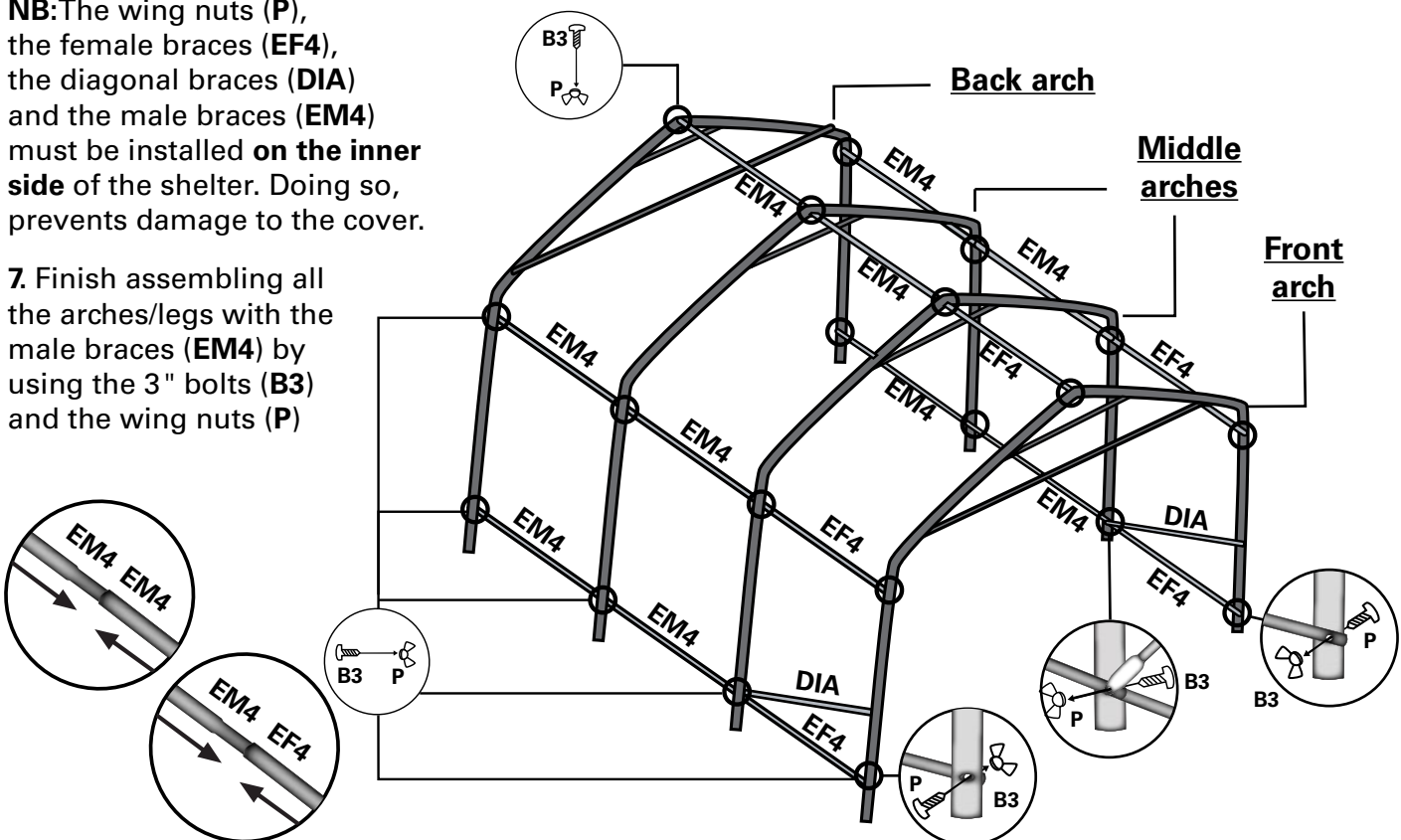

SINGLE CAR SHELTER 12'



8. Ensure that the structure has been installed symmetrically by measuring the distances between points **A** and **D** as well as **B** and **C**. If the two measurements are equal, the structure is symmetrical.

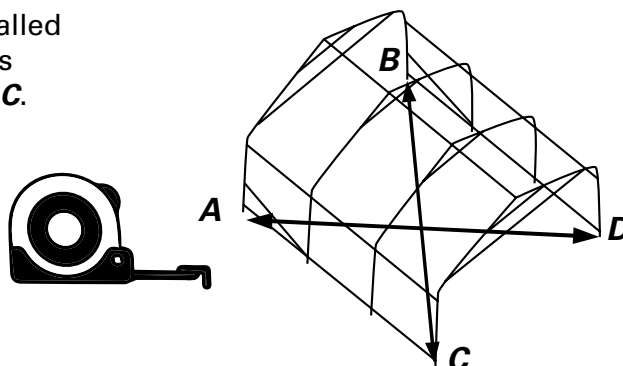

9. Install the shelter cover (**T**) on the structure. Tightly attach the tarp with the ties and the rope.

10. Hang the doors on the door rail (**BP12F + BP12M**) using the shower hooks (**ANNEAU**).

11. Use the S hooks (**S HOOK**) and elastics (**ELASTIQUE**) to attach the doors: Insert the elastic (**ELASTIQUE**) in the grommet, on the opposite side insert the hook (**S HOOK**) and then pinch the hook (**S HOOK**) with a plier.

12. Once the installation is complete and secured, ensure that all wing nuts and the rope are tightened adequately.

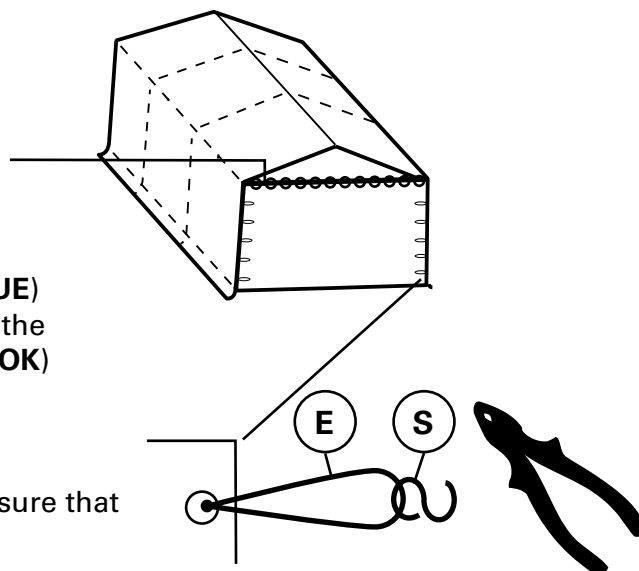

The product is waterproof, except for its seams.

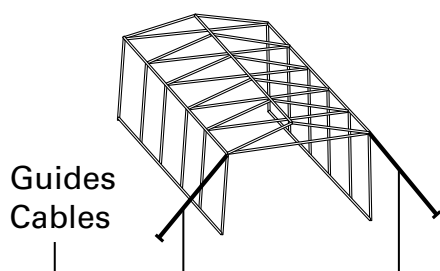

Requirement: Welded fabrics require anti wind bands (sold separately).

Please read the warnings indicated on your shelter tarp to prevent the shelter from failing down or flying away. **Guide cables** and **permanent anchors** (sold separately) are strongly suggested. The anchoring guide posted on our website will illustrate how to use your anchoring system of choice.

www.abrismondial.com/en/installation-plans.